



IDEAL FOR
 MULTI-SCREENS
 INSTALLATIONS

BT8390-VESA200F SYSTEM X™ UNIVERSAL INTERFACE ARMS

FOR SMALL/MEDIUM
 SCREENS

Ideal for single row, multi-screen installations, these interface arms are designed to mount small to medium sized screens in a fixed position along System X horizontal mounting rails. The universal design is compatible with a variety of different screens and allows them to be mounted in either landscape or portrait orientations. Leveling screws on each interface arm provides post installation height adjustment and a mounted depth of 1.88" from the wall allows easy access for cables and connectors.

SPECIFICATION

Recommended screen size	up to 47"
Max load	154lbs
VESA & non-VESA fixings	up to 200 (vertical dimension)
Depth (typical wall mounted install)	2.87"
Supplied in pairs	

FEATURES

- Ideal for menu boards and other multi-screen installations
- Universal design compatible with most screens
- Suitable for landscape or portrait mounting
- Lateral shift - position arms anywhere along the length of the rail
- Includes leveling screws to adjust the screen height
- Safety screws help prevent unauthorized removal of screens
- Simple 'hook-on' installation



47" 120cm VESA 200 154 LBS SYSTEM X

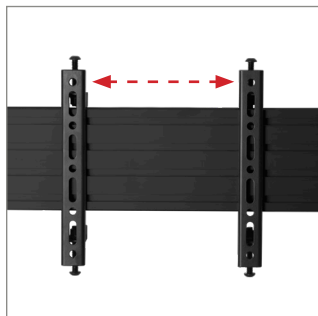

Position arms anywhere along the length of the rail

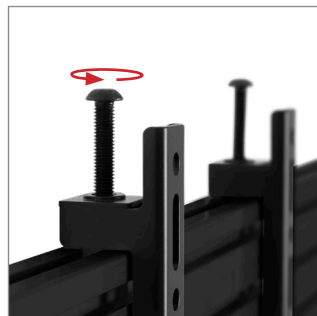

Arms feature leveling screws to adjust the screen height



Safety screws help prevent unauthorized removal of screens



Simple 'hook-on' installation



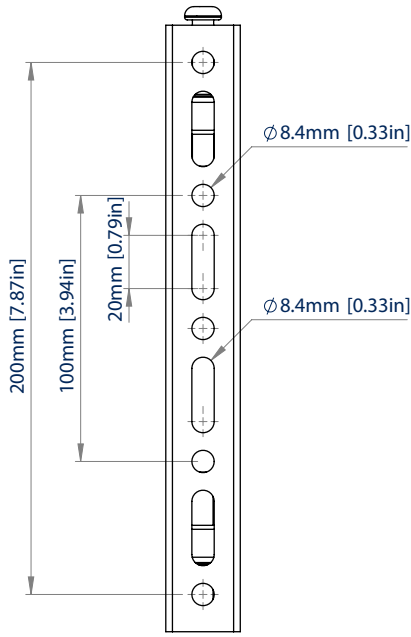

FRONT VIEW



REAR VIEW

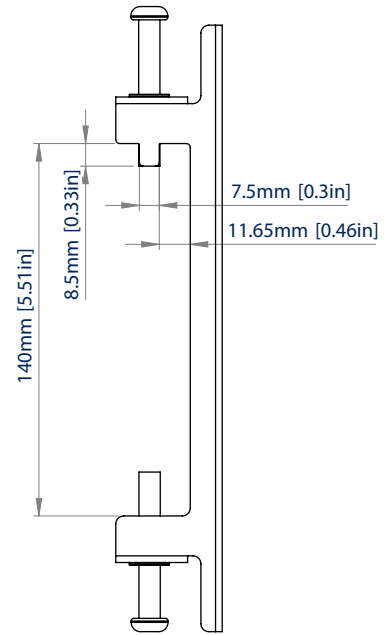

SIDE VIEW

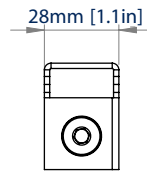

TOP VIEW

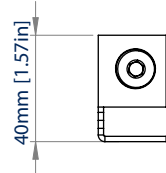

BOTTOM VIEW

PACKING INFORMATION

COLOR:	ORDER REF:	UPC CODE:	MASTER CARTON QTY:	MASTER CARTON WEIGHT:	MASTER CARTON CUBE:
Black	BT8390-VESA200F/B	811867036046	10	23lbs	0.82cuft

RELATED PRODUCTS



Wall Fixing Kits are used to fix mounting rails securely to the wall



Mounting Rails can be attached to columns, walls or poles using System X components



Extension Kits combine mounting rails together to create longer installations



VESA 200 Interface Arms with Tilt mount small - medium sized screens to mounting rails, with a tilt range of up to +20°

B-Tech Av Mounts is a registered trademark of B-Tech International Design & Manufacturing Ltd. All rights reserved. No part of this publication may be reproduced, stored in a retrieval system, or transmitted in any form or by any means, electronic, mechanical, photocopying, recording, or by any information storage and retrieval system, without the prior written permission of B-Tech International Design & Manufacturing Ltd. (BTD).
 We reserve the right to change the technical or physical specifications without prior notice. B-Tech Av Mounts is a registered trademark of B-Tech International Design & Manufacturing Ltd. All rights reserved. No part of this publication may be reproduced, stored in a retrieval system, or transmitted in any form or by any means, electronic, mechanical, photocopying, recording, or by any information storage and retrieval system, without the prior written permission of B-Tech International Design & Manufacturing Ltd. (BTD).
 S5-V1-BT8390-VESA-200F-28102022-EN-US